

GOLDSTONE PARK ELEMENTARY



6287 146 St.
Surrey, B.C.
V3S 3A3

604-595-2767 (Phone)
604-595-2769 (Fax)

goldstonepark@surreyschools.ca
www.surreyschools.ca/schools/goldstonepark

यह बहुत ज़रूरी नोटिस है एसका हिन्दी मे अनुवाद काकाईये।

ਕਿਰਪਾ ਕਰਕੇ ਇਸ ਸੂਚਨਾ ਦਾ ਅਨੁਵਾਦ ਕਰਵਾਓ।

Ito ay importanteng impormasyon. Mangyaring isalin ito sa Tagalog.

Fri, May 14 th	Early Dismissal @ 1:30pm	Mon, May 31 st	Pro-D Day – School Closed
Mon, May 17 th	4:00pm Neufeld Farms Pick up Virtual PAC Meeting @ 6:30pm	Mon, Jun 7 th	Early Dismissal @ 1:30pm
Mon, May 24 th	Victoria Day – School Closed	Thu, Jun 24 th	Last day before Summer Early Dismissal @ 1:30pm

TOMORROW - Early Dismissal Friday, May 14th at 1:30pm.

Principal's Message

It is that time of the year when we bring closure to one school year and begin planning for the next. This is also a time of year when we begin tentative class planning for the next school year. Parents are reminded that a great deal of time, thought and energy go into placing students into classes. Student learning styles and relationships are all part of the process. Of course, parent/guardian input is considered too. Our objective is to create classes which best meet the needs of our students.

Factors considered are the following:

- Intellectual development
- Social/Emotional development
- Students with exceptional needs, in terms of teacher-time, are placed equitably in all classrooms.
- Known student history e.g. same teacher, previous class placements
- Compatibility of students
- The match between student and teacher
- Study/work habits
- Program characteristics

Sometimes, parents are able to provide the school with extra important information that should be considered in determining student placements.

Requests for specific teachers are not allowed. As per the last newsletter, **should you wish to provide the school with extra information, please send a letter addressed to the principal before Friday, May 28th 2021.** Fundamentally, the final decision will be a school-based professional decision.

Drop Off / Pick Up

As the weather gets warmer, please consider walking your child to school or have them bike. Our traffic continues to be an issue and people are not following the rules during pick up and drop off.

DO NOT PARK in the DROP OFF ZONE. If you are parking, park in the city lot.
DO NOT DROP your child off BEFORE you get to the front of the school. Pull all the way forward in the drop-off (right hand) lane otherwise it slows down traffic and impedes the cars driving in the through lane.

Finally, please do not drop your child off in the travel lane. With the congestion we have, it is not safe.



PAC Fundraising

Neufeld Farms

Order pick up is Monday, May 17th at 4:00pm in front of the school.

COBS Bread – Panorama Location ONLY

Raise the Dough Fundraiser at Panorama location. All you have to do is mention Goldstone Park Elementary when you purchase from COBS Bread Panorama and a portion of the sale will be donated to our school. This will be a year round fundraiser!

First Aid Hero

First Aid Hero has their Red Cross Stay Safe and babysitting courses now online! Please be sure to enter the code GoldstonePAC for the school to earn \$8.00 for each registration.



Click the link [here](#) for the First Aid Hero Red Cross Stay Safe Course.

Click the link [here](#) for the First Aid Hero Red Cross Babysitting Course.

PAC NEEDS YOU!!! - ELECTIONS WILL BE HELD ON MAY 17th

**Parents' Advisory Council Meeting/Elections for Next Year's Executive
Monday, May 17 at 6:30**

Please come and join us on ZOOM for our next PAC meeting and get involved in what is happening at your child's school.

<https://us02web.zoom.us/j/83519680281?pwd=VU9zSzFUSzR5WC9nWXVBL1V2Tkk5QT09>

NAMING OF SCHOOL FACILITIES

Schools play a critical role in our neighbourhoods and are the hub of our communities. The names given to our schools are significant and require considerable thought and consultation and should reflect the surrounding community's history and/or geographic area.

With a number of projects currently underway, and new schools opening every school year, the district is focused on engaging each school community to gather potential names for the sites and engage the community to gather feedback on the names currently being considered.

The goal is to have a list of names that have been vetted by our communities at the ready, so they can be used as projects are announced.

NAMES CURRENTLY BEING CONSIDERED

The School Naming Committee, which includes two elected trustees and the Superintendent, has begun the consultation process by bringing forth five potential names for three sites—all of which will begin construction in the coming year. This list of names may be used for other future sites that are pending construction.

The three sites that require names are:



Site 208
17950 25th Avenue*



Site 214
17390 20th Avenue*

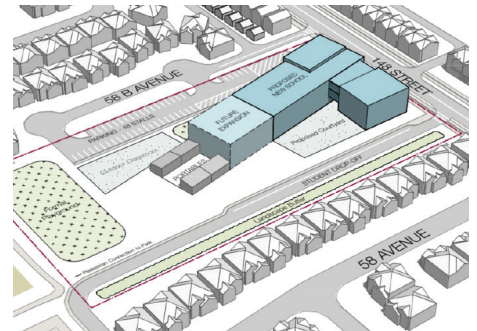

Site 115
5855 148th Street*

*Addresses may change as construction begins

The following school names have been brought forward:

NICOMEKL ELEMENTARY

The Nicomekl River was an early route for settlers that **linked Semiahmoo and Boundary Bays**, running just north of the southern uplands. The Nicomekl was considered **easier to navigate compared to other nearby rivers**, making it an important part of Surrey's history. Site 115 has a clear view of the river.

REDWOOD PARK ELEMENTARY

Situated on a wooded hill south of 20th Avenue, **Redwood Park features a variety of exotic trees, particularly evergreens**, planted by **deaf twin brothers David and Peter Brown**, son of early pioneer David Brown. The park includes a three-storey treehouse, reminiscent of the home in which the brothers lived on the park. Site 208 is adjacent to this park.

ARCHIBALD ELEMENTARY

144th Street was **once known as Archibald Road** in Surrey, when a section of it became the homestead of a Mr. Archibald near 80th Avenue. A trail linked the homestead to Yale Road and was later upgraded to a road. As 144th Street extends south into White Rock, the connecting road is still known as Archibald Road there. Although it is not on this street, site 115 is in this neighbourhood.

LITTLE CAMPBELL ELEMENTARY

The Little Campbell River **served as an entrance for pioneers and early settlers** in the mid-to-late 1800s, allowing them to navigate South Surrey in a time before trails and roads. The river is **home to diverse wildlife and plant species**, including five species of Pacific salmon and trout. This river runs near site 214.

KENSINGTON PRAIRIE

Originally named by H.T. Thrift to promote settlement in the area, Kensington Prairie is a rich agricultural area south of the Nicomekl River that stretches to the southern upland and extends east to the New Westminster Southern Railway line. Previously, **Surrey Schools had a Kensington Prairie Elementary** at 168th Street and 32nd Avenue, a one-room schoolhouse that opened in 1887 and closed its doors in 2006. Site 208 is in this neighbourhood.

WE WANT TO HEAR FROM YOU!

Tell us what you think about the names being considered or share your ideas for school names! We will be engaging staff and the surrounding school communities throughout the month of May 2021 to gather feedback.

To share your thoughts and ideas, send us an email at comm-office@surreyschools.ca