



École Woodward Hill Elementary

6082 - 142nd St., Surrey, B.C. V3X 1C1

PH: 604-594-2408 • Fax: 604-594-2336 • www.surreyschools.ca/schools/woodwardhill

Newsletter 3 October 18, 2021

Ey'Swayel Woodward Hill families,
Happy October, Woodward Hill! Students and staff are settling into the routines of school. It is always a joy to visit classrooms to observe and support the learning.

Orange Shirt Day

Our OSD was very successful. Teachers spoke with their students about the legacy of the residential school system. A short video and story was shared with students and [can be seen here](#). Students and staff wore orange shirts to symbolize a commitment to understand the truth about residential schools. While learning about the RSS, students were also exposed to the importance of [Truth and Reconciliation](#). All children painted an eagle feather the contribute to our Eagle Wings display that will remain up all year. Our eagle mascot represents honour, respect, courage, commitment, and wisdom – fitting complements to Truth and Reconciliation. Thank you to everyone who showed support by wearing orange.



Remembrance Day

Remembrance Day is approaching and we are planning how to honour the men and women, past and present, who serve. Like last year, we are asking families to send in photos of friends and family who have served or are serving in the Armed Forces, so they can be honoured in our slide show. Please send electronic photos to woodwardhill@surreyschools.ca or forward hard copies to the office for scanning. Also, students in Beavers, Brownies, Cadets or Guides are asked to wear their uniform during the day. More details to follow. Please contact the office if you have any questions.

Hallowe'en

Halloween is just around the corner. Here are the details you need to know:

- **PAC Pumpkin Patch!**
Our awesome PAC is bringing back the pumpkin patch to Woodward Hill on October 27. PAC is looking for volunteers to help place the pumpkins on the grass field in the morning – 7am start!
- **Donations to food bank – We Scare Hunger!**
All students are encouraged to bring a non-perishable food item to school between October 18 – 29. Collection boxes will be placed in classrooms and will be collected by our leadership student. Let's see how many boxes of food we can contribute to our local food bank!
- **Costumes**
Everyone is encouraged to dress-up for Hallowe'en! Pictures will be taken and shared with teachers to show their students. In keeping with school district policy and regulation, please keep toy weapons and scary masks at home during the school day.
- **Pumpkin Carving**
Students are encouraged to bring in their carved pumpkin on Thursday October 28. Please label your pumpkin with your child's name so that it can be picked up on Friday October 29. We are looking forward to seeing your imagination at work.

Early dismissal dates

An early dismissal has been scheduled for Thursday October 21. Students are dismissed at 1:35pm. The purpose of early dismissal is to receive feedback on your child's progress to date. Teachers will either provide a written interim or meet with parents to discuss their child's learning.

Digital resources

All Surrey students have access to a wealth of online information and resources to support their learning. The resources are located on the school district's website under Students – Homework Help or click [here](#). **The username and password to logon is sd36bc.** Available resources include Tumblebooks, Digital Magazines for Kids, Worldbook Encyclopedia, tab-vue (non-fiction eBooks), Canadian Points of View and so much more!

School budget

Below is information on Woodward Hill's budget 2021-22.

School: Woodward Hill School Courier #: 212

* Select a school above, to update data

TOTAL ALLOTTMENT \$ 74,076

PROJECTED ENROLMENT

KF	1 - 7	Total	Spec. Ed.
86	630	716	38

BUDGET ALLOCATION DETAILS

Base Allocation per Elementary School	1 @ \$ 5,507	\$ 5,507
KF Supply per student	86 @ 57	4,893
Grades 1-7 Supply per student	630 @ 46	29,169
Special Ed Supplement per SE Student	38 @ 47	1,786
Core Music Allotment per Elementary School	1 @ 180	180
SP. ED. Mileage Supplement per SE Student	38 @ 31	1,189
Postage per student	716 @ 1	752
Photocopier per student	716 @ 11	8,019
Agendas per student	716 @ 1	752
Field Trips per student	716 @ 5	3,723
Equity Adjustment		(1,360)
Drawtime		6,306
Carry Forward Surplus (Deficit) from Prior Year		6,000
School Equity Allocation (Prelim Allocation)		7,160

TOTAL ALLOCATION BASED ON STUDENT HEADCOUNT \$ 74,076

SUPPLIES	11 - 0020 - 5100 - 212 - 000	\$ 54,087
FIELD TRIPS	11 - 0020 - 3310 - 212 - 000	3,723
POSTAGE	11 - 0020 - 4330 - 212 - 000	752
PHOTOCOPIER	11 - 0020 - 4360 - 212 - 000	8,019
SPECIAL ED MILEAGE	11 - 0020 - 3420 - 212 - 000	1,189
TOTAL PARENT ACCOUNT	11 - 0020 - 9990 - 212 - 000	\$ 67,770
CLERICAL DRAWTIME	11 - 0020 - 1750 - 212 - 000 (independent of parent account)	6,306

Morning drop-off and afternoon pick-up

When driving onto school property to drop-off or pick-up your child curbside, please remain in your vehicle. The front of the school is drop-off/pick-up only and not meant for parking. If you need more time to drop-off/pick-up your child, please park on one of the neighbouring streets and walk to the school. We ask that you turn off your vehicle's engine if you arrive early to pick up your child. Also, please use the crosswalks on 142nd Street and in the school's parking lot. Please refer to the map below for more information (courtesy Cindy Dalglish – PAC president).

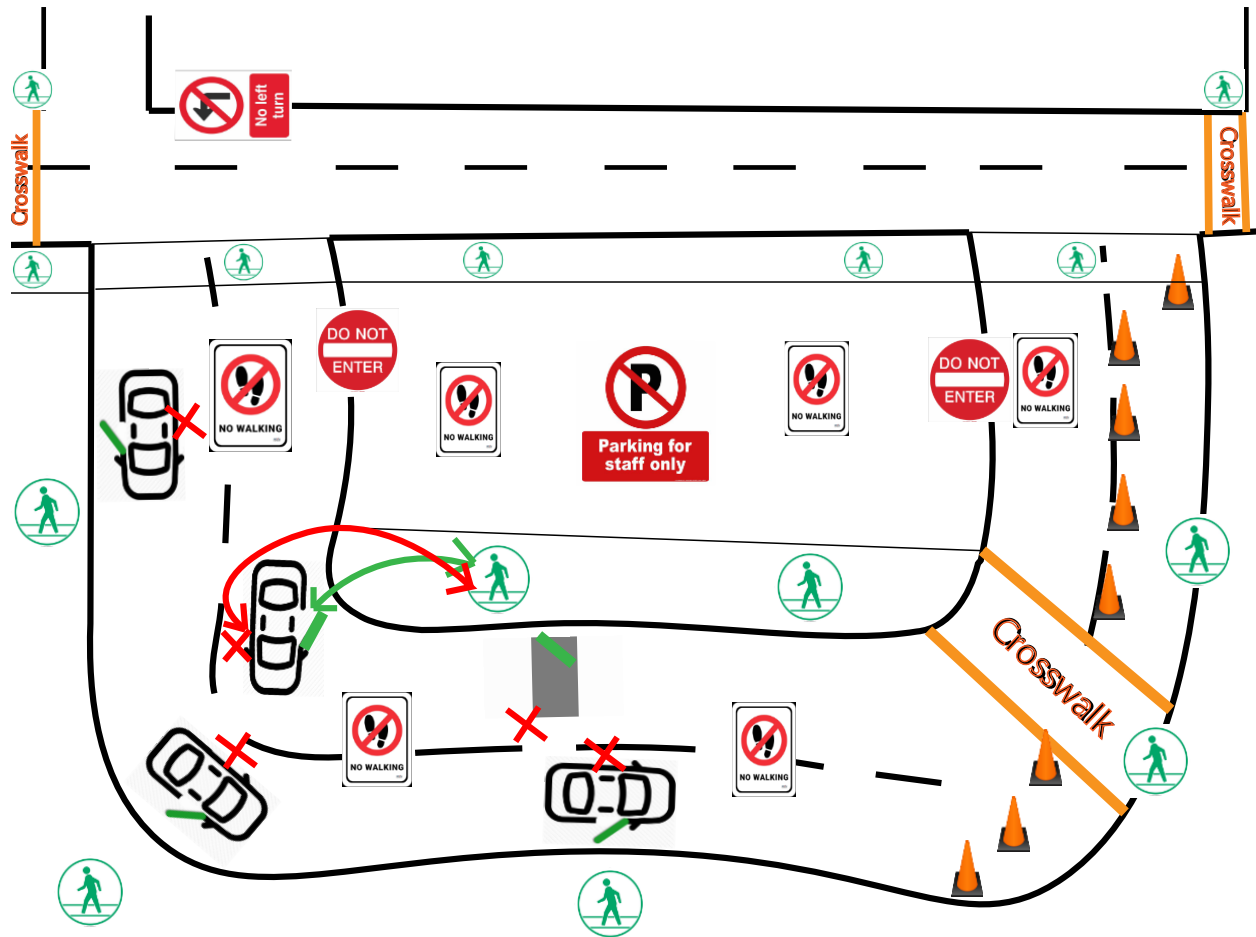

Message from our Parent Advisory Council (PAC)
 Follow/join the École Woodward Hill PAC on Facebook
 at: <https://www.facebook.com/groups/EcoleWoodwardHill>.

PAC Executive

President	Cindy Dalglish
Vice President	Bernadette Mullen
Secretary	Monica Singh
Treasurer	Jaismeen Soni

Members at Large

Andrea Phillips, Carly Paice, Stacie Palivos, Erica Campbell, Angela Skillen, Jassy Hans, Steve Binnag, Nirmal Binnag

How to contact your PAC

Email president@woodwardhillpac.ca

Upcoming dates

Oct. 21	Early dismissal paper interims or learning conferences
Oct. 22	Non-instructional day – classes not in session
Oct. 18-29	Food drive – We Scare Hunger
Oct. 28-29	Carved Pumpkin display
Oct. 29	Halloween costume
Nov. 4	Diwali
Nov. 5	Photo retake day
Nov. 10	Remembrance Day – school not in session
Nov. 11	Non-instructional day