

**SEMAHMOO
SECONDARY
SCHOOL**

1785-148 Street
SURREY BC V4A 4M6
Phone: 604-536-2131
Fax: 604-536-4970

DATE OPENED: 1966
MINIBERGARTEN: 0
ESTABLISHED: 1900
CAPACITY OTHER: 0
SITE AREA (HA): 8
FACILITY AREA (SQM): 15187

LEGAL DESCRIPTION
SEARCHED PD 17/7/09
LOT 34, SEC. 15, TOWNSHIP 1
NW/4, PLAN 2982 (SAME
PROPERTY AS SITE #65), SHOW
5128759 OWNER: BC HYDRO RE:
EASTERLY 3.048 METRES
NORTHWEST CORNER SURFACY
OWNER: BC TEL RE: EASTERNLY 10
FEET 11/12/00, MONTGAGE
UZZO'S OWNER-MONTREAL TRUST
SEE 99804C AND U22079 RE: OF
S146173 SUPPLEMENTAL TO 9904C



FACILITY PLANNING

MAIN FLOOR

SCALE: 1:650
SHEET: 1 OF 1
DRAWN BY: T. TRINCHIEY
LAST UPDATED: NOV. 10, 2009
SITE NUMBER:

049

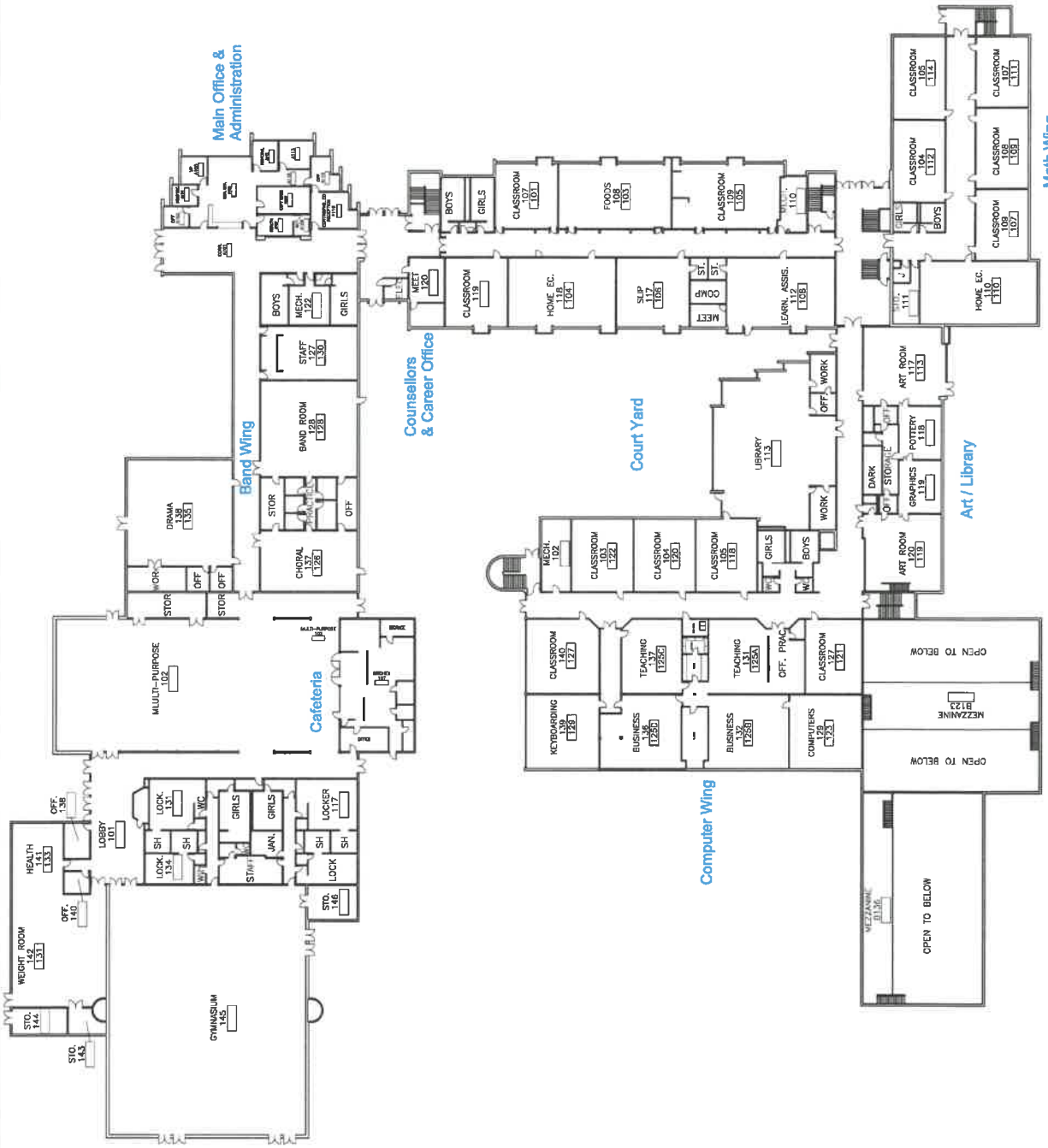

Main Office & Administration

Band Wing

Counsellors & Career Office

Court Yard

Computer Wing

Art / Library

Math Wing

**SEMAHMOO
SECONDARY
SCHOOL**

1785-148 Street
SURREY, BC V4A 4M6
Phone: 604-536-2131
Fax: 604-536-4970

DATE OPENED: 1966
KINDERGARTEN: 0
ELEMENTARY: 0
SECONDARY: 630
CAPACITY OTHER: 0
SITE AREA (HA): 8
FACILITY AREA (SQM): 15187

LEGAL DESCRIPTION
REGISTERED 09/07/86
LOT 34, SEC. 45, TOWNSHIP 1
NW/4, PLAN 24622 (GAME
PROPERTY AS SITE #69), S80W
STR5679 OWNER: BC HYDRO RE:
EASTERLY 3.046 METRES
OWNER: BC TEL. RE: STR5673
OWNER: BC TEL. RE: STR5673
FEET 11/12/80, MORTGAGE
LUZ079 OWNER: MONTREAL TRUST
SEE 9904C AND U2079 RE: OF
S146173 SUPPLEMENTAL TO 9904C



FACILITY PLANNING

SECOND FLOOR

SCALE: 1:350
SHEET: 1 OF 1
DRAWN BY: T. TINCHEY
LAST UPDATED: JAN 15, 2007
SITE NUMBER:

049

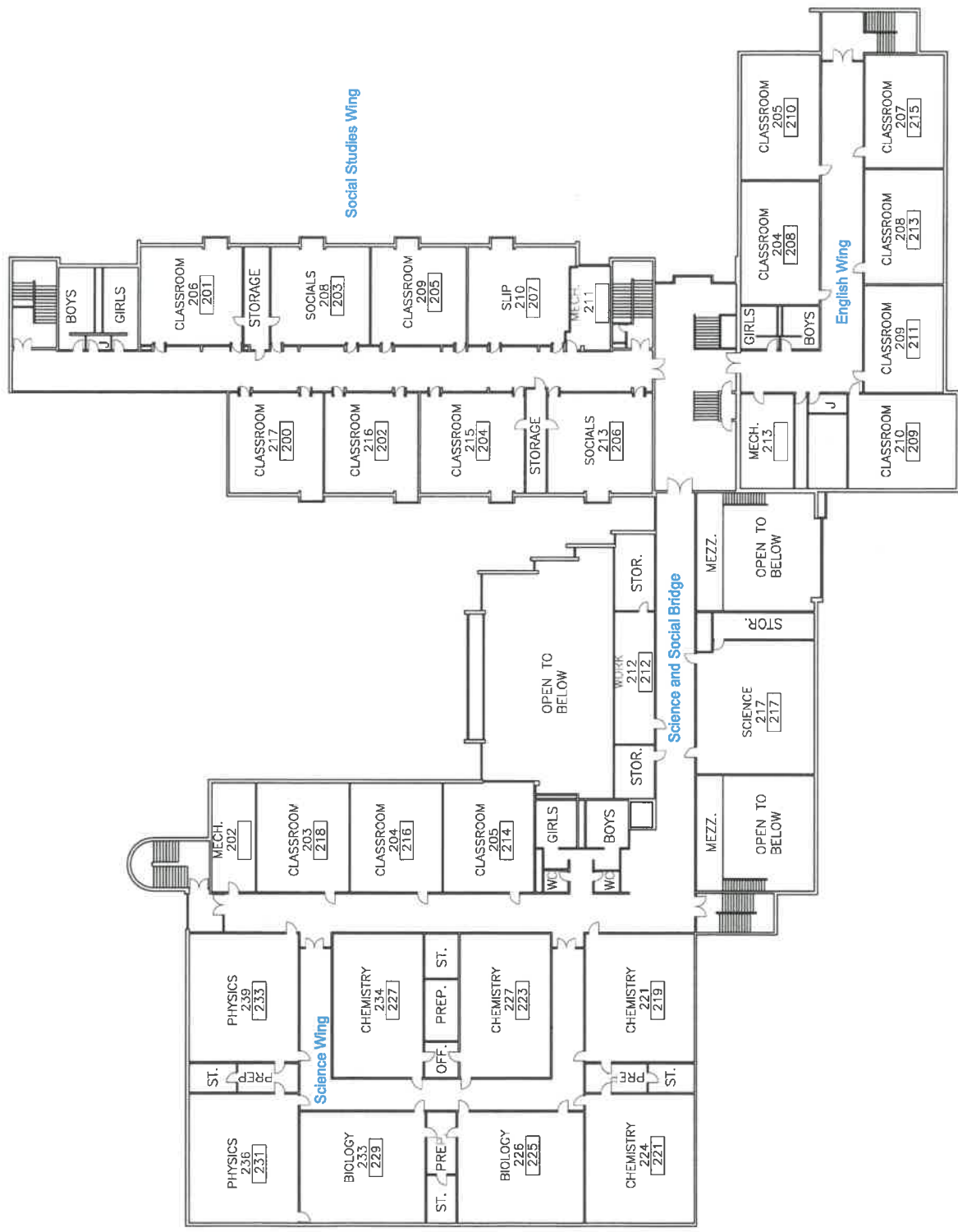

**SEMAHMOO
SECONDARY
SCHOOL**

1785-148 Street
SURREY BC V4A 4M6
Phone: 604-536-2131
Fax: 604-536-4970

DATE ORDERED: 1966
NUMBER OF YEARS: 0
ELEMENTARY: 0
SECONDARY: 1300
CAPACITY OTHER: 0
SITE AREA (HA): 8
FACILITY AREA (SQM): 15187

LEGAL DESCRIPTION
SEARCHED 92/07/06
LOT 38, SEC. 15, TOWNSHIP 1
HWY. PLAN 2945Z (SAME
PROPERTY AS SITE #95), SROW
S12/29 OWNER: BC HYDRO RE:
12/11/00 ASSESSMENT: \$14473
OWNER: BC TEL RE: EASTERN TO
FEET 11/12/00 - MORTGAGE
LIZDOR'S OWNER-MONTREAL TRUST
SEE 9980AC AND U22079 RE: OF
S146173 SUPPLEMENTAL TO 190AC



FACILITY PLANNING

BASEMENT

SCALE: 1:300
SHEET: 1 OF 1
DRAWN BY: C.L.O
LAST PRINTED: MAY 08, 2008
SITE NUMBER:

049

