



PANORAMA PARK ELEMENTARY SCHOOL

12878 62nd Avenue, Surrey, BC V3X 2E8 • Phone: (604) 596-0963 • Fax: (604) 594-0467

Back to School 2020

September 2, 2020



Dear Panorama Park Families,

We would like to take this opportunity to share with you information regarding our opening week of school. We hope you enjoyed the summer and sunshine. Thank you to our families who took the time to complete the survey that was sent out last week. Recognizing that school will look and feel different for many of our students, staff have two days, as allocated by the Ministry of Education, to orientate themselves with health and safety protocols. This will take place on Tuesday, September 8 and Wednesday, September 9. Students will not be in attendance on these two days.

We will have two days of one-hour sessions on Thursday, September 10 and Friday, September 11 for all our students to familiarize themselves with health and safety protocols. On these days students will attend school in small groups for one hour each day where they will connect with a staff member and a small group of their peers, review safety protocols and practice measures that have been put in place. Please note that students will not yet be placed in learning groups and teachers will be helping students to physically distance. With this letter, a schedule has been attached indicating where students should meet and wait for a teacher. In addition, while not mandatory, students are welcome to bring and wear a mask during the day. All students will be receiving two re-useable masks from the school district, but will not receive them until the second week when they are placed in the learning groups. Students will be placed into their learning cohorts (classes) for Monday, September 14.

Unfortunately, at this time, we will not be allowing any visitors inside the school building. If you need to arrange a meeting with a staff member, please make an appointment. Parents who will be dropping off and picking up, please respect physical distancing and wait outside in designated areas for drop off and pick up for your child's group.

If you are not registering your children for the Surrey Blended: Elementary Transition Program, the first day of school will be Thursday, September 10. Students attend on the following dates and times:

Thursday, September 10 & Friday September 11

- Students in Grades 1, 2, 3, & 4 attend for 1 hour only from 9:00 am to 10:00 am.
- Students in Grades 5, 6, & 7 attend for 1 hour only from 11:00 am to 12:00 pm.
- Students in Kindergarten attend 12:30 pm to 1:30 pm 1 hour only on one of these days.

Monday, September 14

- Students in Grades 1, 2, & 3 attend from 8:35 am to 2:35 pm.
- Students in Grades 4, 5, 6, & 7 attend from 9:05 am to 2:35 pm.

Tuesday, September 15

- Students in Grades 1 to 7 from 8:35 am to 2:35 pm.

We are looking forward to welcoming your children, our students back to school.

J Dhaliwal

J. Dhaliwal
Principal

P Pekova

P. Pekova
Vice Principal

**** Please scroll down for the schedules and school map ****



Panorama Park Elementary School

Our students have been divided up into distinct groups for their orientation on Thursday, September 10 & Friday, September 11. We are expecting that students will be in attendance both days. Students have been divided into smaller groups by their last names for the orientation. When students arrive at the school, they will need to find the location where their group is meeting. While waiting for the classroom doors to open, please have the children line up ensuring that they are following the physical distancing expectations and staying six feet apart. The teacher will take attendance and begin their orientation around some health & safety protocols to help keep everyone safe. All students will be dismissed from their designated specific classroom location.

9:00 am - 10:00 am – Grades 1, 2, 3, & 4 Orientation
Meet in front of the designated external (outside) classroom doors

Grade One

Students (Surname)	Teacher	Room Number
A – Br	Mrs. Duimel	401
Ch - Gre	Ms. Hamilton & Ms. Riarh	402
Gro - Mathe	Ms. Nilsson	404
Mathel - Sand	Ms. Carcamo	403
Shah -Upp	Ms. Hamal	405

Grade Two

Students (Surname)	Teacher	Room Number
A – Ch	Ms. Thiara & Ms. Traher	501
Chh - Har	Ms. Nair	606
Hel - Kir	Mrs. Schroeder & Ms. Traher	605
Kl - Sang	Ms. Atwal	305
Shab -Wray	Ms. Joshi	309

Grade Three

Students (Surname)	Teacher	Room Number
A – Cru	Ms. Umlas	206
Dhal - Gre	Ms. Taylor	406
Hari - Lou	Ms. Jain	204
Man - Sain	Ms. Brown & Ms. Aquing	304
Sal -Virk	Mr. Gill	506

Grade Four

Students (Surname)	Teacher	Room Number
A – Coo	Ms. Short	308
D - Kaur	Ms. Nisar	604
Kh - Pom	Ms. Hundal	505
Ran - Sug	Mr. Yeh	205

11:00 – 12:00 – Grades 5, 6, & 7 Orientation
Meet in front of the designated external (outside) classroom doors

Grade Five

Students (Surname)	Teacher	Room Number
A – Dela Cru	Ms. Taylor	203
Deo - Ga	Ms. Short	308
Geo - Mem	Ms. Nair & Mrs. Schroeder/ Traher	605/606
Min - Sah	Mr. Yeh	205
San - War	Ms. Jain	204

Grade Six

Students (Surname)	Teacher	Room Number
A – Bo	Ms. Taylor	203
Bra- Geo	Ms. Short	308
Gi- Naw	Mrs. Pekova	203
Oil - Singh	Mr. Yeh	205
Soh - Upp	Ms. Jain	204

Grade Seven

Students (Surname)	Teacher	Room Number
A – Bh	Mrs. Hundal	506
Bh- Dh	Mr. Gill	505
Do- Kah	Ms. Brown & Ms. Aquing	304
Kat - Oil	Ms. Sanghara	504
Pad - Sand	Ms. Nisar	604
Sans -Zah	Ms. Thiara & Ms. Traher	501

Kindergarten Orientation (Group A)

Thursday, September 10 12:30 – 1:30
Meet in front of the designated external (outside) classroom doors

Students (Surname)	Teacher	Room Number
A - Bo	Mrs. Duimel	401
Ch -Gre	Ms. Hamilton & Ms. Riarh	402
Gul - Kat	Ms. Nilsson	404

Kindergarten Orientation (Group B)

Friday, September 11 12:30 – 1:30
Meet in front of the designated external (outside) classroom doors

Students (Surname)	Teacher	Room Number
Kha -Par	Mrs. Duimel	401
Reh - San	Ms. Hamilton & Ms. Riarh	402
San - Than	Ms. Nilsson	404

Panorama Park Elementary

September 2020

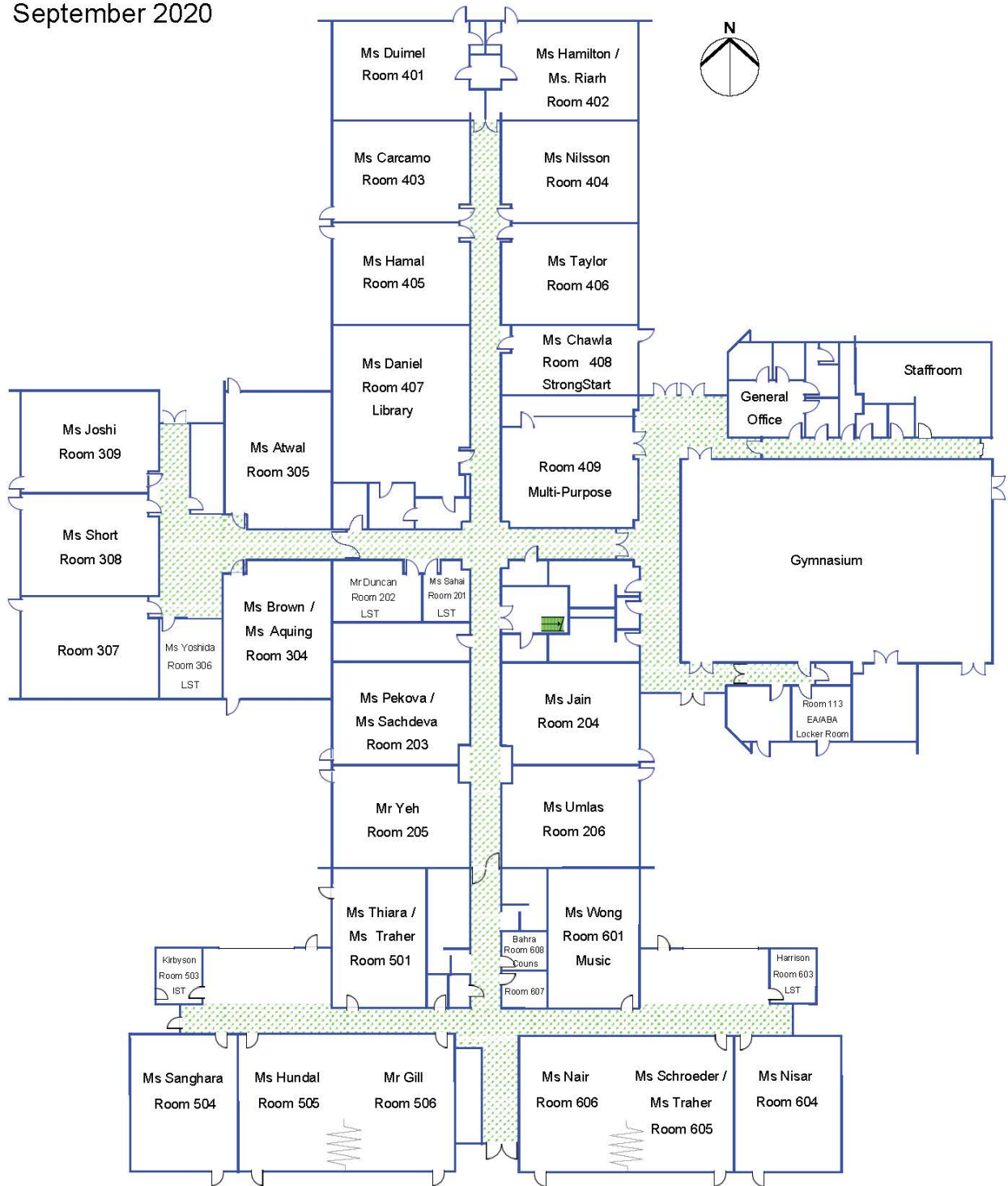

Panorama Park's Bell Schedule

GRADES K - 7

Welcoming Bell	8:30 am
Start of School Bell	8:35 am
Morning Session	
Primary	8:35 - 10:15 am
Intermediate	8:35 - 10:30 am
Recess	
Primary	10:15 - 10:30 am
Intermediate	10:30 - 10:45 am
Second Session	
Primary	10:30 - 11:50 am
Intermediate	10:45 - 11:50 am
Lunch	11:50 - 12:35 pm
Primary - Play Time	11:50 - 12:15 pm
Intermediate - Eating Time	11:50 - 12:15 pm
Primary - Eating Time	12:15 - 12:35 pm
Intermediate - Pay Time	12:15 - 12:35 pm
Afternoon Starting Bell	12:35 pm
Afternoon Session	12:35 - 2:35 pm

