

Board of Education of School District No. 36 (Surrey)

Sketch Plan Presentation
Site 207 - New Elementary

June 10, 2020



Introduction

Project Team + Steering Committee

SD36 Project Manager *Autumn Sweet*

Thinkspace *Ray Wolfe*
Danika Irvine

Steering Committee *Lynda Reeve*
Christy Northway
Shaun Nelson
Antonio Vendramin
Wendy Crowe

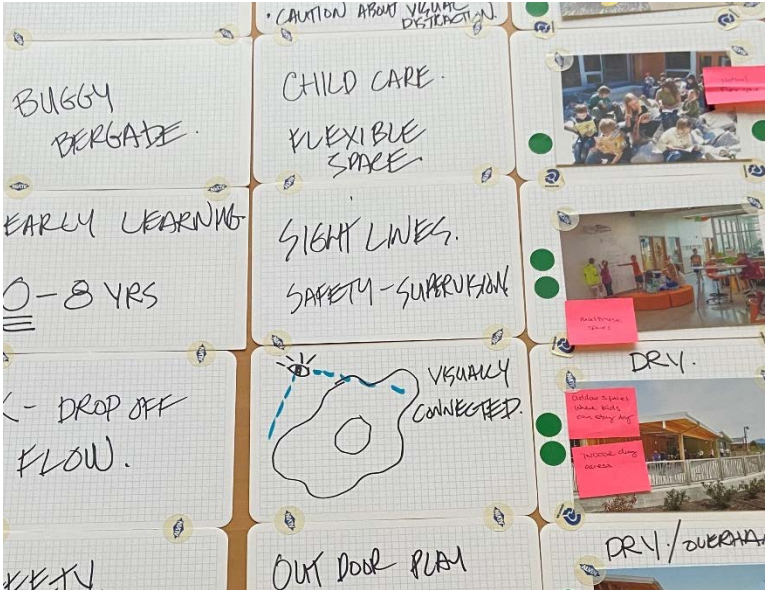

Agenda

1. Context Plan
2. Site Plan
3. Floor Plans
4. Sections
5. Massing Sketches



Site

Context Plan

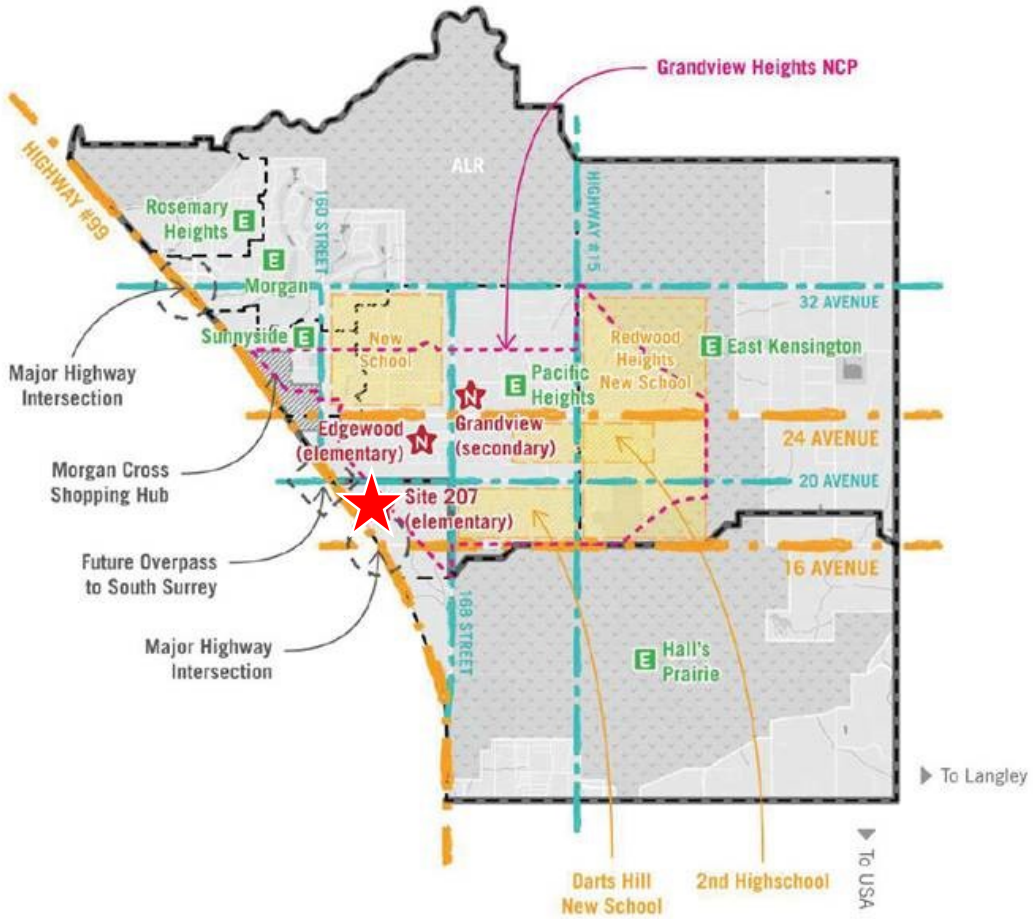

Site Site Plan

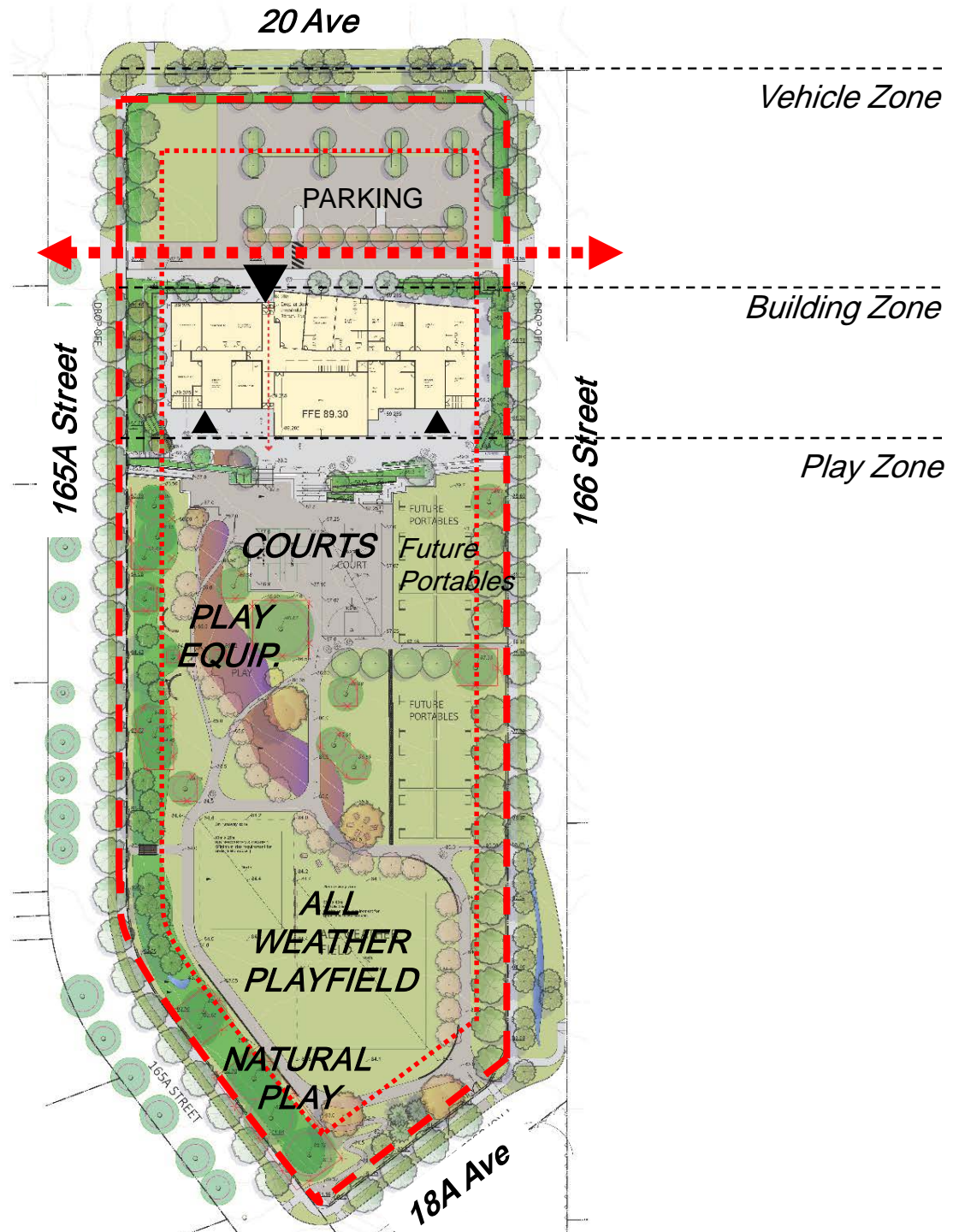

Design

Axonometric

-  CLASSROOM
-  PROJECT SPACE
-  SPECIAL EDUCATION
-  KINDERGARTEN
-  CHILD CARE
-  GYM
-  LEARNING COMMONS
-  MULTI-PURPOSE
-  ADMINISTRATION
-  CIRCULATION
-  STORAGE/MECHANICAL
-  WASHROOM

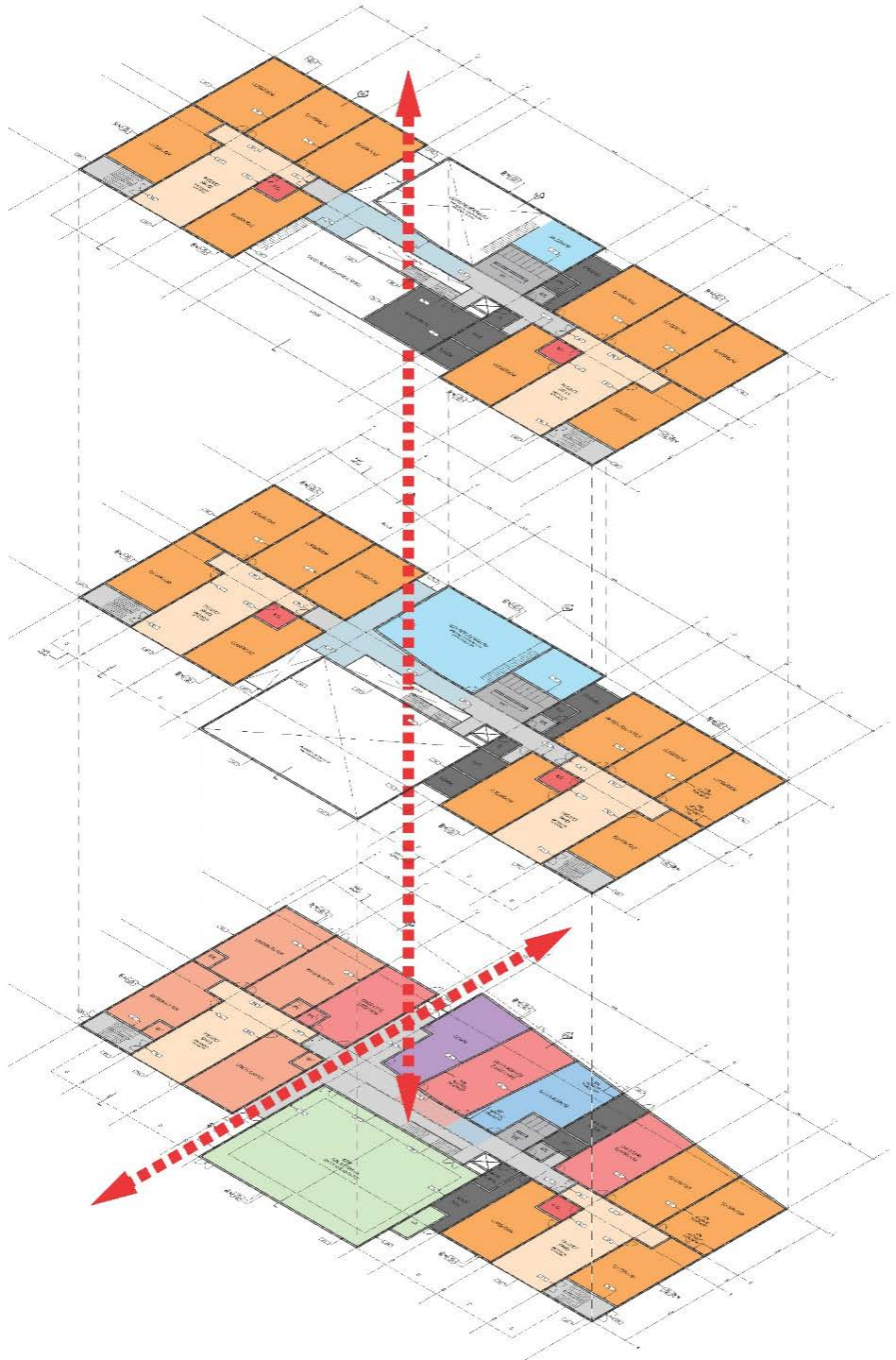

Plans

LEVEL 1

- CLASSROOM
- PROJECT SPACE
- SPECIAL EDUCATION
- KINDERGARTEN
- CHILD CARE
- GYM
- LEARNING COMMONS
- MULTI-PURPOSE
- ADMINISTRATION
- CIRCULATION
- STORAGE/MECHANICAL
- WASHROOM

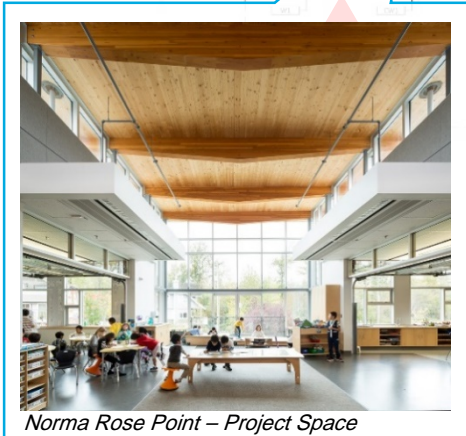

Norma Rose Point – Project Space

Plans

LEVEL 2

- CLASSROOM
- PROJECT SPACE
- SPECIAL EDUCATION
- KINDERGARTEN
- CHILD CARE
- GYM
- LEARNING COMMONS
- MULTI-PURPOSE
- ADMINISTRATION
- CIRCULATION
- STORAGE/MECHANICAL
- WASHROOM

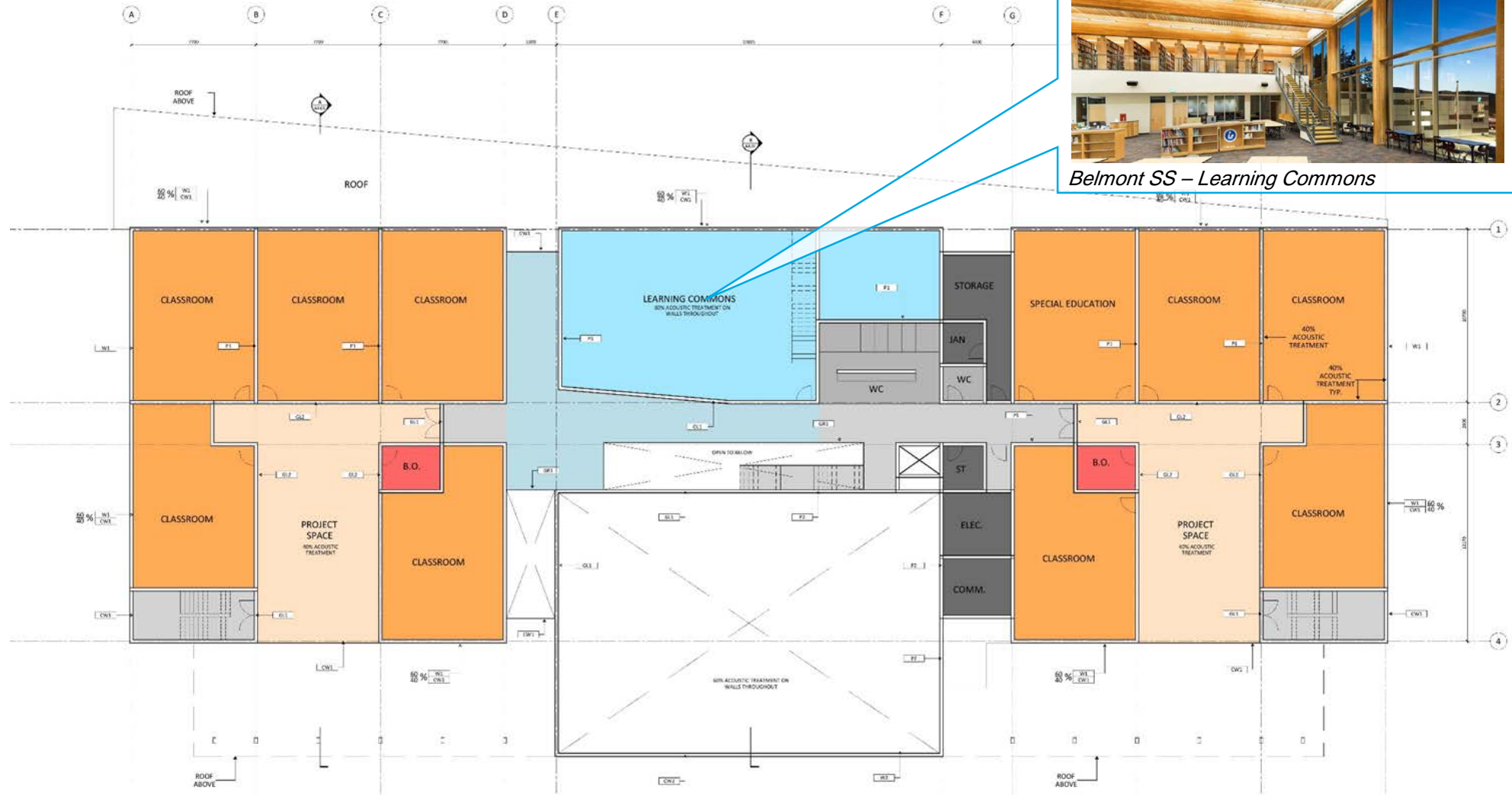

Plans

LEVEL 3

- CLASSROOM
- PROJECT SPACE
- SPECIAL EDUCATION
- KINDERGARTEN
- CHILD CARE
- GYM
- LEARNING COMMONS
- MULTI-PURPOSE
- ADMINISTRATION
- CIRCULATION
- STORAGE/MECHANICAL
- WASHROOM



Norma Rose Point – Project Space

Design Sections

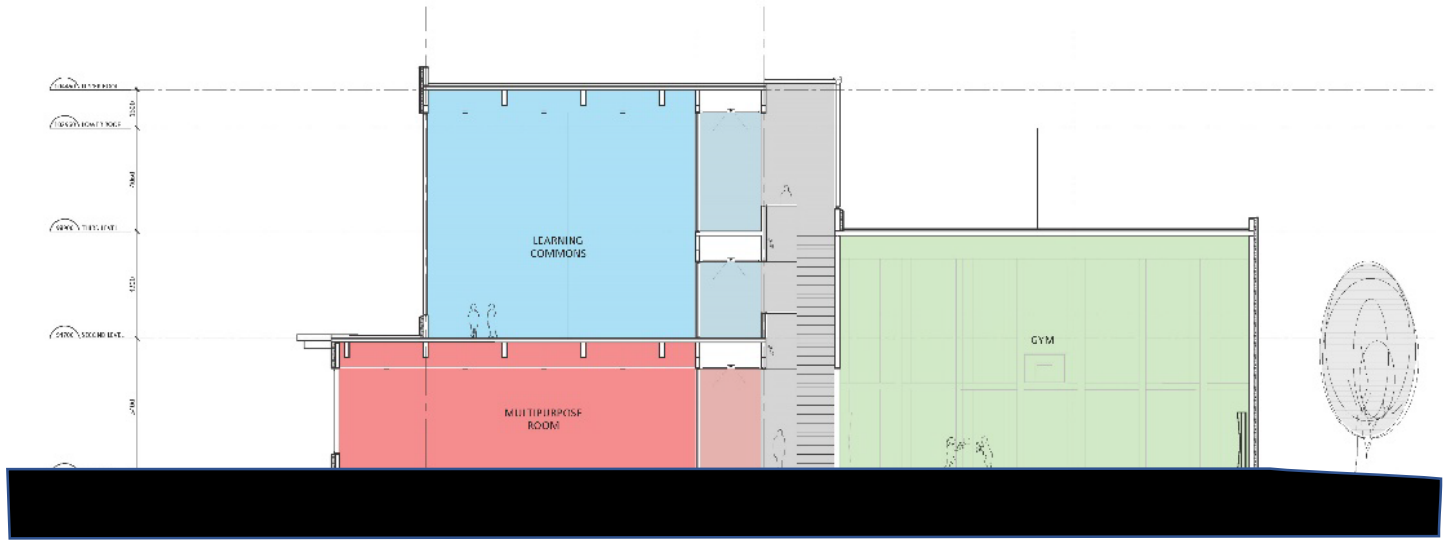
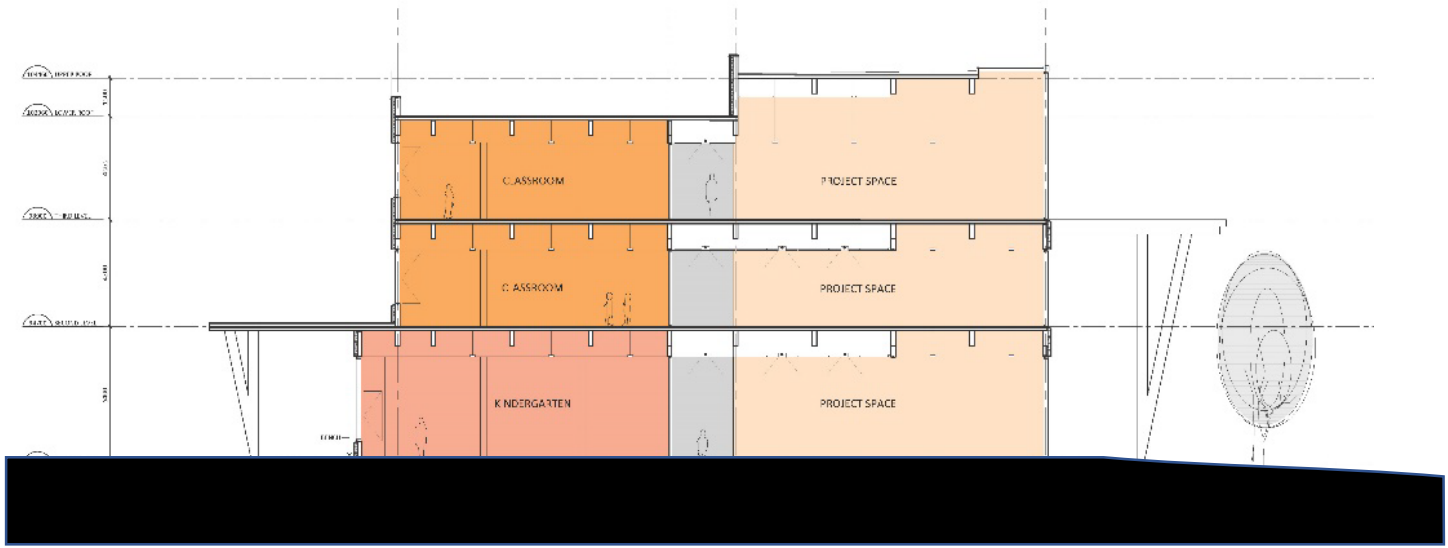

Design

Massing Sketches

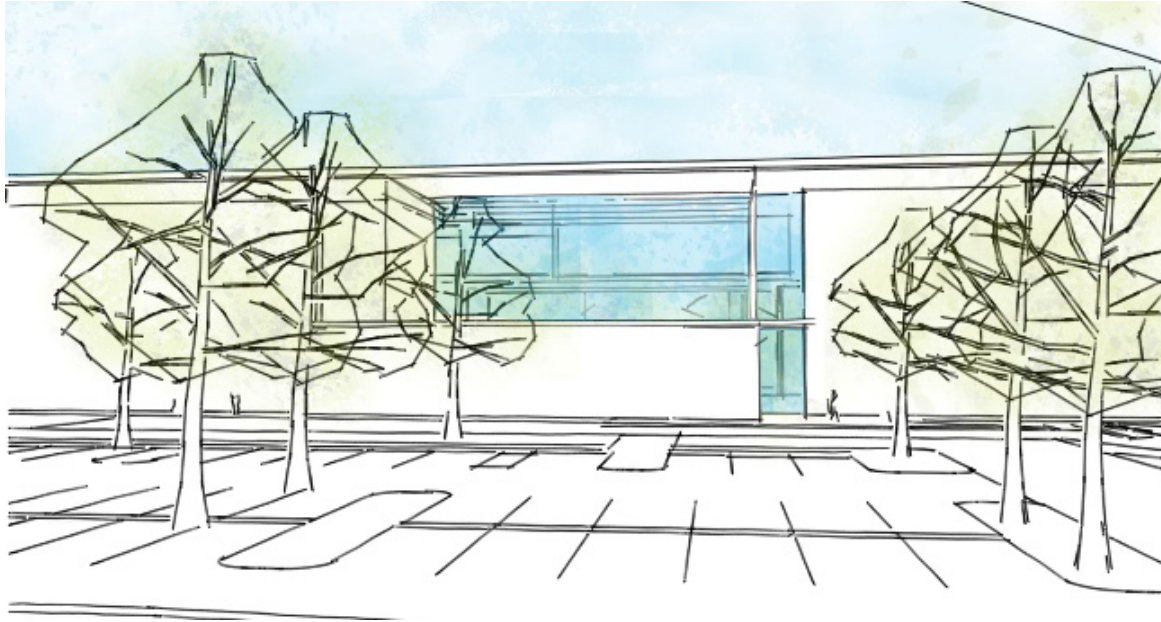

Material Palette



Tender
Fall 2021

School Opening
Fall 2023

Thank You!

thinkspace

